

THE INFORMATION ON THIS DOCUMENT IS THE PROPERTY OF BHARAT HEAVY ELECTRICALS LIMITED. IT MUST NOT BE USED DIRECTLY OR INDIRECTLY IN ANY WAY DETRIMENTAL TO THE INTEREST OF THE COMPANY.

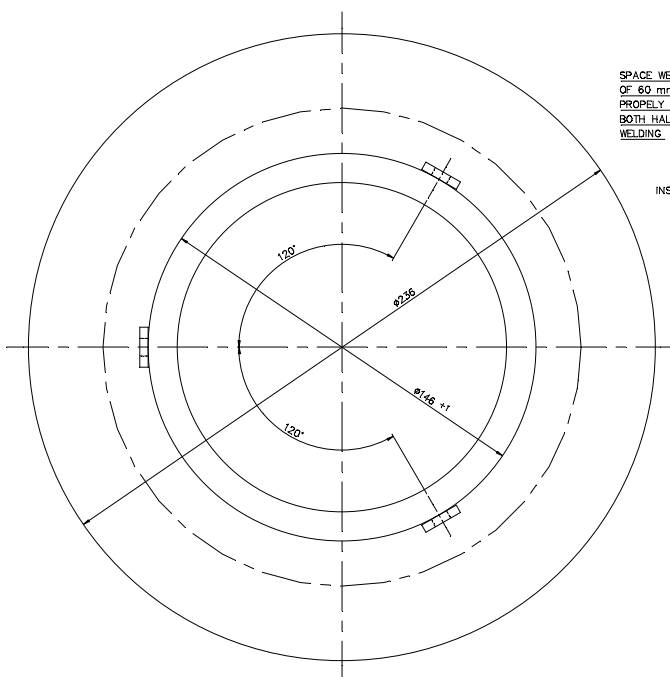

SPACE WELD 8 LG. WITH GAP OF 60 mm (MAX.) & CLEAN PROPERLY ALIGN THE EDGES BOTH HALF SHELLS BEFORE WELDING.

INSULATION ACC. TO SG 14007

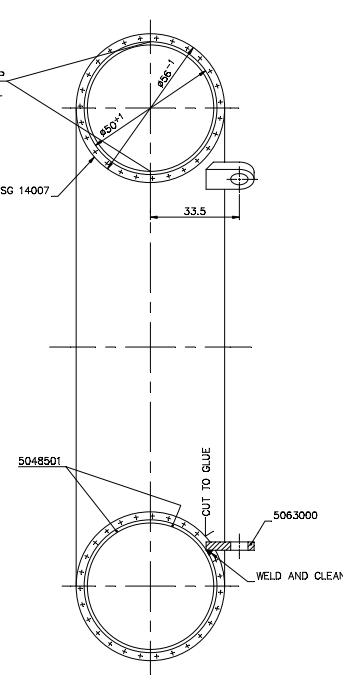

TOOL LIST	
ITEM	DESCRIPTION
1463348	WELDING FIXTURE
1520135	WELDING FIXTURE FOR LUG

- NOTES :-
- ROUND SURFACES TO BE SMOOTH, CLEAN & FREE FROM SHARP EDGES, DENTS, SCRATCHES, PAINTING MARK ETC. AS PER SG 14005.
 - APPLY DR. BECK'S SMO LUFT-1A VARNISH ON COMPLETE SURFACE BEFORE PAPER INSULATION.
 - QUALITY & ACCEPTANCE NORMS PER SG-14028.

110 KV-M Δ 150 KV, 220 KV

VAR. NO.	REMARKS	VAR. NO.	ITEM NO.	DESCRIPTION	DRAWING NO.	ITEM NO.	MATL. CODE	UNIT WGT.	QTY.
28		28				28			

ADDITIONAL INFORMATION

STATUS OF DRAWING

DISTRIBUTION OF PRINTS

SWE	SWM	TCX
1	3	1

DRG. REDRAWN (DCA. NO.)

GRADING RING SUB ASSY.

5086531

INVENTORY NO. SIGN AND DATE

REV.	DATE	ALTERED CHECKED APPROVED	REV.	DATE	ALTERED CHECKED APPROVED
03					

भारत हेवी इलेक्ट्रिकल्स लिमिटेड BHARAT HEAVY ELECTRICALS LTD. BHOPL	गण/NAME V.KUMAR	दिनांक/DATE 16.5.82
भारत हेवी इलेक्ट्रिकल्स लिमिटेड BHARAT HEAVY ELECTRICALS LTD. BHOPL	गण/NAME RKS	दिनांक/DATE 2.6.82
भारत हेवी इलेक्ट्रिकल्स लिमिटेड BHARAT HEAVY ELECTRICALS LTD. BHOPL	गण/NAME RKS	दिनांक/DATE 2.6.82