

FIRST ANGLE PROJECTION

DRG. NO. SK-1454

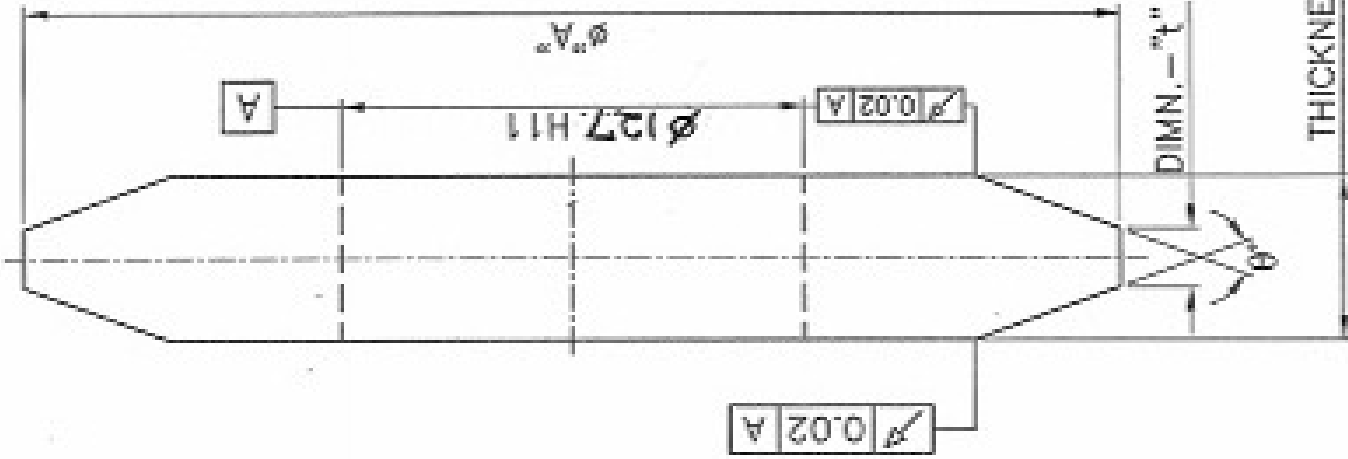

SL. NO.	ϕ "A"	DIMN. "t"	THK. "T"	M/C	θ°
1	400	10.0	32	WMW R900	40° 80°
2	350	10.0	32	HOFLER	40°
3	350	8.00	25	HOFLER	40°
4	400	8.00	25	WMW R900	40° 80°
5	300	10.00	32	PFALTER	80°
6	400	16.0	45	R900	80°
7	300	16.0	45	PFALTER	80°
8	350	16.0	45	R 900	80°

⑧

THICKNESS "T"