

41100 01 109 3 DRG.DWG

(ALL DIMENSIONS ARE IN MM)

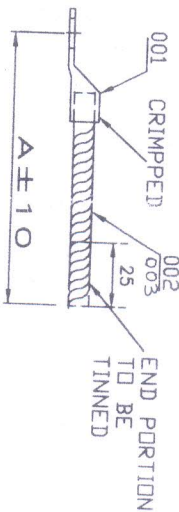
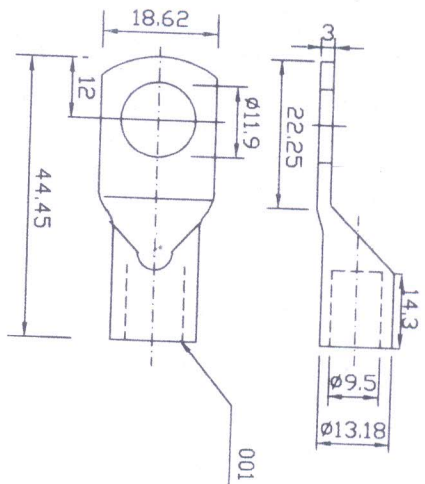

- NOTE: -
- 1) TUBULAR LUG TO BE ELECTRO TINNED COATING TK. AS PER TABLE 1, OF IS 1359 - 1992. SERVICE, GRADE NO.3. CLASSIFICATION CODE SN 15 Lm MIN.
  - 2) LENGTH OF FLEX. COPPER BRAID TO CUT TO SUIT ASSY.REF.TABLE

DETAIL'S - X

VAR DIMENSION NO	A
00	5 00
01	5 00

VAR NO	QTY	QTY	REMARKS	VAR NO	QTY	QTY	REMARKS	VAR NO	QTY	QTY	REMARKS
001	-	001	003 FLE.COPPER BRAID 7.2 x 0.9 x 1/8 LG.	001	001	001	001 FLE. COPPER BRAID 10 x 2 x 1/4 LG.	001	001	001	001 TUBULAR LUG 7E, TYPE-1

INVENTORY NO.	SIGN. DATE	REF. DRG NO. -	THE INFORMATION ON THIS DOCUMENT IS THE PROPERTY OF BHARAT HEAVY ELECTRICALS LTD. IT MUST NOT BE USED DIRECTLY OR INDIRECTLY IN ANY WAY DETRIMENTAL TO THE INTEREST OF THE COMPANY.
REV	DATE	ALTERED	CHECKED
01	15-12-00	APPROVED	APPROVED
REV	DATE	ALTERED	CHECKED
01	15-12-00	APPROVED	APPROVED
ADDITIONAL INFORMATION STATUS OF DRAWING B DISTRIBUTION OF PRINTS CPE-1 QCCTCB)-1 CPM-2 TRXCTCB)-1 IN BOM VAR 01 ADDED. IN TABLE VAR 00 WAS 800 & VAR 01 WAS 850 RESPLY.			
DEPT CPE CODE 408		BHARAT HEAVY ELECTRICALS LTD. BHOPAL	
TUBULAR LUG & ASSY. FOR CVT		BHP9047020960 (FOR VAR 01)	
DRAWING NO. 3 601 10 00114		DATE 12-5-00	

COMP FILE NO.3011014.DWG