

The information on this document is the property of BHARAT HEAVY ELECTRICALS LIMITED. It must not be used directly or indirectly in any way detrimental to the interest of the company.
 INVENTORY NO. 003 3025-LT/212627F-1
 SIGNS & DATE REF. DRG. NO. Z-S

REV	DATE	ALTERED	REV	DATE	ALTERED
06	9/23	CHECKED	05	3/50	CHECKED
SURFACE FINISH WAS CPP			NOTE 1 & 3 MODIFIED AND NOTE 4 ADDED.		

ADDITIONAL INFORMATION
 STATUS OF DRAWING **STD**
 DISTRIBUTION OF PRINTS TRE-1, TRM-1, TCX-1

STYLE LIST

STYLE	ITEM INCLUDED	DESCRIPTION REMARKS	RECORDED	
			SIGN	DATE
ST604763	001	NUT M16	[Signature]	14-11-86
ST604764	002	NUT M8	[Signature]	14-11-86
ST604767	003	NUT M10	[Signature]	14-11-86
ST604775	004	NUT M12	[Signature]	14-1-87

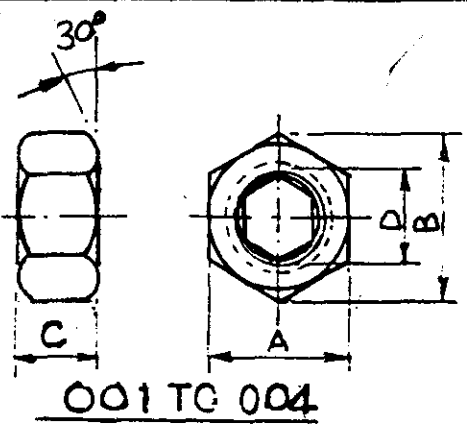

TABLE FOR DIMENSIONS.

ITEM NO	NOM DIA D	FLATS	CORNERS	THICKNESS	PITCH
		A (MAX)	B (MIN)	C (MAX)	COARSE THREAD
001	M16	24.00	26.75	17.00	2.00
002	M8	13.00	14.38	9.00	1.25
003	M10	17.00	18.90	11.00	1.5
004	M12	19.00	21.00	13.00	1.75

NOTES:-

- MATL FOR NUT**
HTS-PROPERTY CLASS 8 OF IS 1367 (P+VI)
- FOR MATERIAL AND OTHER DETAILS OF THREAD INSERT REFER STD DRG TR2005.
- SURFACE FINISH-ZPP**
TO BE DONE AS PER STD SHEET TR10017P.
ZPP IS TO BE DONE ON NUT BEFORE FITTING WIRE THREAD INSERT. PLATING IS NOT REQUIRED ON THREAD INSERT.
- NUT WITH THREAD INSERT SHALL MEET THE OF REQUIREMENT OF PROOF LOAD TEST AS PER IS 1367 PT-VI.

SEE NOTES SEE NUT TABLE WITH THREAD INSERT

65	75	25	27	29	58	59	34	45	55	56	58		
REMARK	ITEM NO.	DESCRIPTION			MATL. CODE	A157	UNIT WT	46	MATL. SPCN.	54	C	66	QTY

CARD TYPE-3 → 28 28 → CARD TYPE-1 28 → CARD TYPE-

BHARAT HEAVY ELECTRICALS LTD.
BHOPAL

DRN: [Signature] NAME: Hussain Hussain
 CHD: [Signature]
 APPD: [Signature]
 DATE: 8-10-86

DEPT. TRE	GRADE OF UN TOL DIM. C M F	SCALE	WEIGHT (Kg)	REF. TO ASSY. DRG.	ITEM NO.	75 NO. OF ITEM
CODE 406						

TITLE: **NUT WITH WIRE THREAD INSERT**
 DRAWING NO.: **4 49970 00059 06**
 SHEET NO: **1** NO OF SHEETS: **-**