

FIRST ANGLE PROJECTION

(ALL DIMENSIONS ARE IN mm)

| | | | | |
|--------------------------------|----------------------------|------------------------|-------------------------|------------------------|
| REV. DATE | ALTERED BKT | REV. DATE | ALTERED | ADDITIONAL INFORMATION |
| 07 11.05.06 | CHECKED RKB APPROVED NB | 06 09.05.06 | CHECKED RKB APPROVED | |
| IN BOM MATERIAL WAS CORRECTED. | | STATUS OF DRAWING B | | |
| DCA. NO. 25710 | | DISTRIBUTION OF PRINTS | | |
| DCA. NO. 25686 | | SWE | SWM | TCX |
| | | 1 | 3 | 1 |

IMPORTANT NOTE: -

- MATERIAL SHOULD BE FREE FROM CRACKS, POROSITY, AGL, DIM A DIM B INCLUSION/DEPOSIT OF DUST OR ANY OTHER FOREIGN BODY 174±0.2 150±0.2 MATERIAL SHOULD BE FREE FROM MOULDING DEFECTS. 002 140±0.2 116±0.2
- THE PORTION MARKED C -- C SHOULD BE FREE FROM MOULDING DEFECTS 186±0.2 146±0.2 CRACKS IN ACROSS & TRANSVERES DIRECTION TO THE

SEE NOTE 2

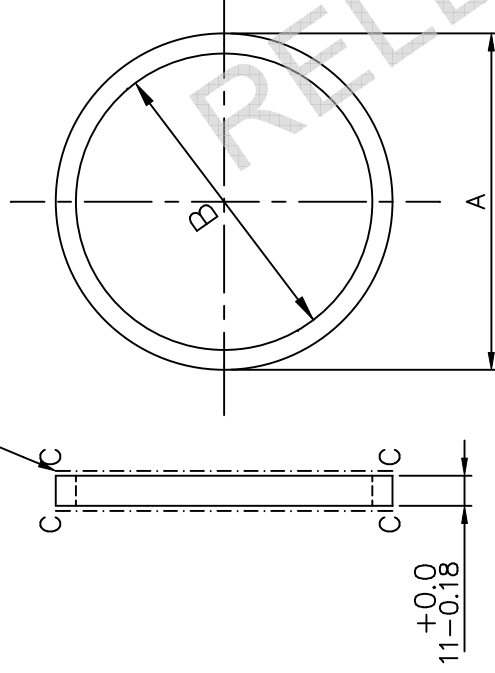

- MATERIAL SHOULD BE FREE FROM SURFACE PORES RESULTING FROM MOULDING DEFECTS.
 - MATERIAL SHOULD BE SUITABLE FOR WORKING TEMP. UP TO 85°C AND SHOULD HAVE VERY GOOD RESISTANCE AGAINST AGING IN OUTDOOR APPLICATION AND TROPICAL CLIMATE.
 - MATERIAL SHOULD BE SUITABLE FOR 25% COMPRESSION.
- PACKING: - RINGS SHOULD BE SEPERATELY PACKED IN PLASTIC BAGS.

FINISH: - NATURAL

| | | | | | | |
|-----------------|--------------------------|------------|-------------|----------|------|-------|
| BP909944027004 | 11TKx174x174 EPDM RUBBER | | | | | 0.666 |
| BP9099437048003 | 11TKx210x210 EPDM RUBBER | | | | | 0.97 |
| BP9069437031002 | 11TKx140x140 EPDM RUBBER | | | | | 0.016 |
| BP9009436680001 | 11TKx174x174 EPDM RUBBER | | | | | 0.021 |
| | | | | | | 0.01 |
| REMARKS | DESCRIPTION | MATL. CODE | MATL. SPCN. | UNIT WT. | QTY. | |
| 7525 2729 | 58 59 46 | A B C | | 68 | | |

28 → CARD TYPE-3 28 → CARD TYPE-1 28 → CARD TYPE-2



भारत हेवी इलेक्ट्रिकल्स लिमिटेड
ओ पल
BHOPAL
BHARAT HEAVY ELECTRICALS LTD.
BHOPAL

| | | | |
|-------------|------------|---------------|-------------------|
| कार्टा ड्रन | कार्टा नाम | कार्टा दिनांक | वे. नं. की संख्या |
| R.K.S. | R.K.S. | Sd/- | 22.02.86 |
| जोडा चक्र | जोडा चक्र | Sd/- | 22.02.86 |
| उत्पादन | उत्पादन | Sd/- | 27.02.86 |

| | | | |
|----------|---------------------|-----------|-------------------------------|
| DEPT SWE | अं. टा. गाय की सेवा | अं. वजन | अं. संख्या |
| कोड 409 | UNTOLODMS. GR. | SCALE NTS | WEIGHT (K.G.) |
| | | | REF. TO ASSY DRG. 35217001520 |
| | | | 35213030604 |

शीर्षक/TITLE
GASKET
(PORCELAIN CLAD VCB)
आरेख क्र./DRAWING NO.
4 521 70 01508
पृष्ठ क्र./SHT. No. 01 पृष्ठों की संख्या/NO. OF SHT. 01

THE INFORMATION ON THIS DOCUMENT IS THE PROPERTY OF BHARAT HEAVY ELECTRICALS LIMITED IT MUST NOT BE USED DIRECTLY OR INDIRECTLY IN ANY WAY DETRIMENTAL TO THE INTEREST OF THE COMPANY

REF. DRG. NO.

SIGN. & DATE

INVENTORY NO.