

Name: End position stopper

1. THIS ASSEMBLY HAS FOLLOWING TWO COMPONENTS:

- a. END POSITION STOPPER ASSY.
- b. BUSH

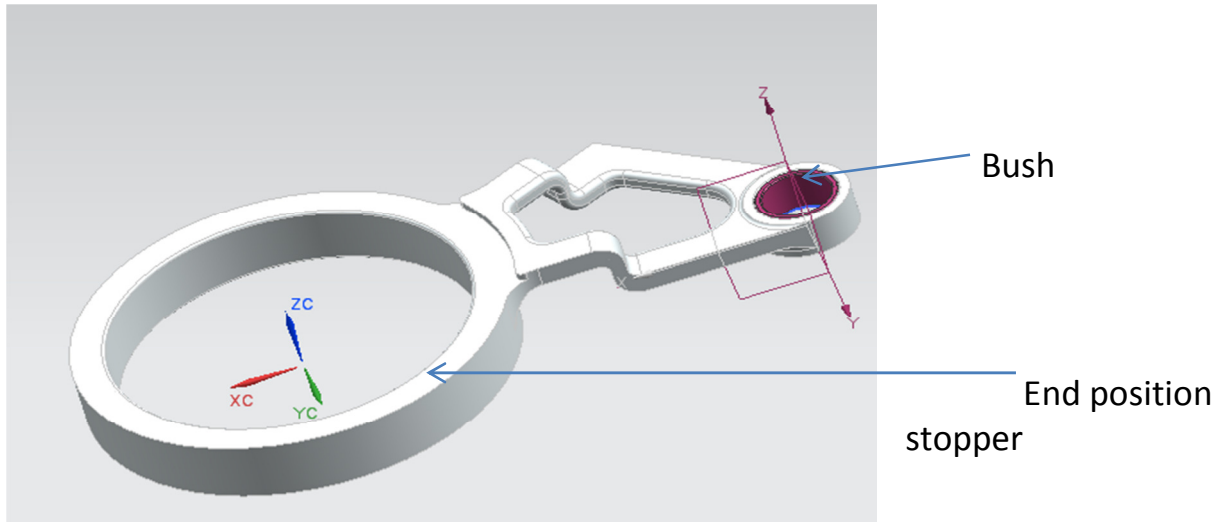

2. DRAWING NO. - 5012588

3. Weight- 1.377 kg

4. Raw Material for End position Stopper:

Malleable Iron Casting Black earth

The phosphorus or iron content shall not be more than 0.12, percent.

Raw Material for Bush: *Lead tin Bronze Casting*

5. MECHANICAL PROPERTIES:

Tensile:

When tested in accordance with IS: 1608, the test pieces shall show then following properties:

Tensile strength : 350 N/mm², min.
0.2% Proof stress : 200 N/mm², min.
Elongation Lo=3D : 10 percent, min.

Hardness: IS: 1500 150 HB, maximum.

6. FINISH:

All castings shall be property fettled and dressed and all surfaces shall be thoroughly Cleaned. The machined surfaces shall have the surface finish as indicated in the drawing.